

GEARBOX TYPE: QSS-800-S

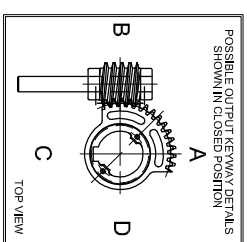
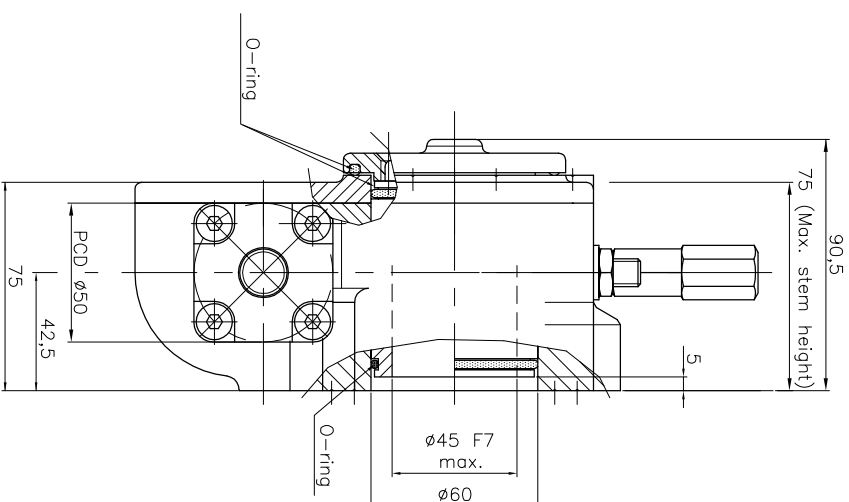
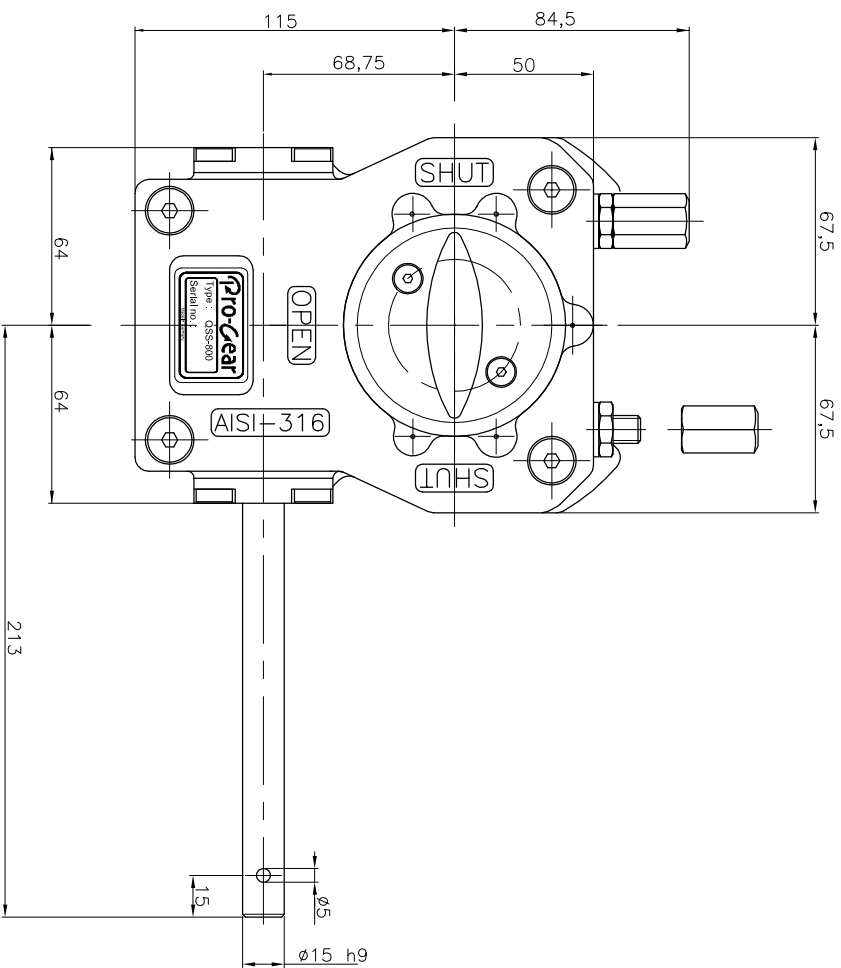

No rights can be obtained from this drawing
Drawing can be changed without notice

TECHNICAL DATA

NAME	: QSS-800 S
Travel	: 90° ±5° at both ends
RATIO	: 40 : 1 (quarter turn)
TURNS TO CLOSE	: 10
APPROX. WEIGHT	: 7.68 kg. (16.93lb.) excl. bore and handwheel
MAX. INPUT TORQUE	: 60 Nm (44.25 lbf.ft.)
MAX. OUTPUT TORQUE	: 800 Nm (590.05 lbf. ft.)
MECH. ADV.	: 13.3% (+/- 10%) (Values measured by fully loaded gearbox)

MOUNTING DETAILS

BOLT CIRCLE	MIN. : $\varnothing 70$ [2.76] 4x M8 (F07)	MAX. : $\varnothing 125$ [4.92] 4x M12 (F12)
BORE	MIN. : $\varnothing 15$ [0.59] (pilot-bore)	MAX. : $\varnothing 45$ [1.77] or [127] [01.06]

Pro-Gear



dimension in MM.

Scale : none

Drawing number :
DC-QSS-800-S-01

Revision :
02

This document is property of PRO-GEAR GmbH. Neither this or its content may be copied or used in any other way detrimental to the interest of PRO-GEAR, acceptance of this document shall constitute acknowledgement of the foregoing conditions