

# GEARBOX TYPE: 3000-MO-D

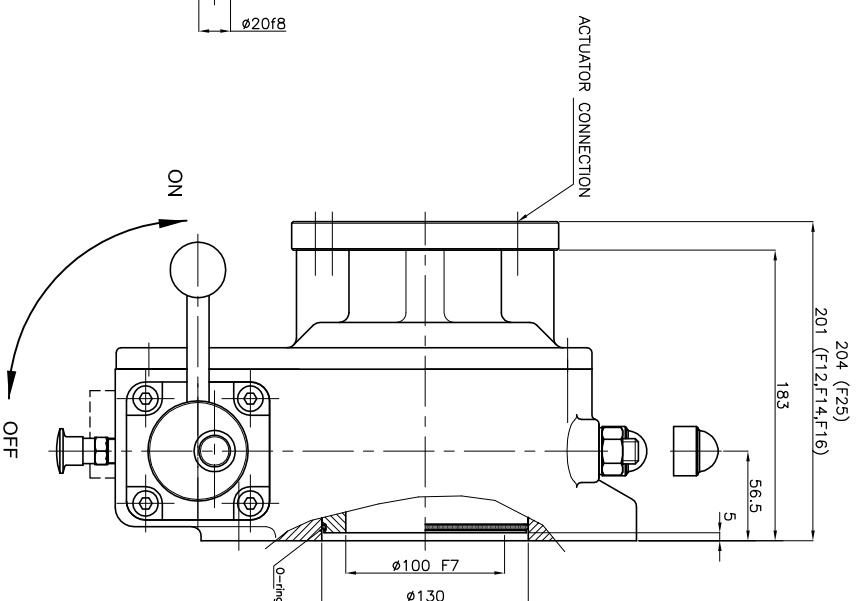
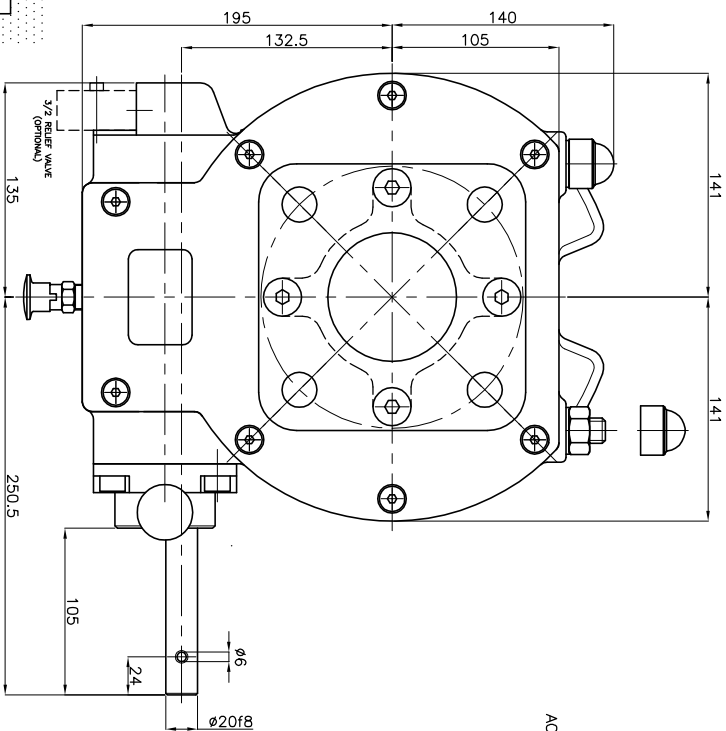

## TECHNICAL DATA

NAME	: 3000 MO-D
Travel	: 90° ±5° at both ends
RATIO	: 72 : 1 (quarter turn)
TURNS TO CLOSE	: 18
APPROX. WEIGHT	: 40.3 kg. ( 88.84lb. ) excl. bore, coupling and handwheel
MAX. INPUT TORQUE	: 155Nm ( 114.52 lbf.ft. )
MAX. OUTPUT TORQUE	: 3000 Nm ( 2212.69 lbf. ft. )
MECH. ADV.	: 19.4% (+/- 10%) (Values measured by fully loaded gearbox)

## MOUNTING DETAILS

VALVE CONNECTION	MIN.	: $\varnothing 165$ [6.50] 4x M20 (F16)
	MAX.	: $\varnothing 254$ [10.0] 8x M16 (F25)
BORE	MIN.	: $\varnothing$ (pilot-bore) or $\square$ (---)
	MAX.	: $\varnothing 100$ [3.94] or $\square 55$ [2.16]
ACTUATOR CONNECTION	MIN.	: $\varnothing 140$ [5.51] 4x $\varnothing 18$ (F14)
	MAX.	: $\varnothing 254$ [10.0] 8x $\varnothing 18$ (F25)
SHAFT DIMENSIONS	MIN.	: $\varnothing$ (pilot-bore) or $\square$ (---)
	MAX.	: $\varnothing 79$ [3.11] or $\square 55$ [2.16]

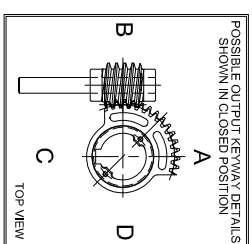

# Pro-Gear



dimension in MM.

Scale : none

Drawing number : DC-3000-MO-D-01

Revision : 02

This document is property of PRO-GEAR GmbH. Neither this or its content may be copied or used in any other way detrimental to the interest of PRO-GEAR, acceptance of this document shall constitute acknowledgment of the foregoing conditions.