

# GEARBOX TYPE: Q 12000-S

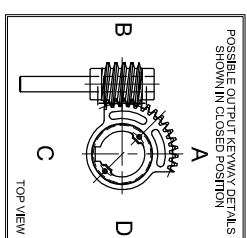
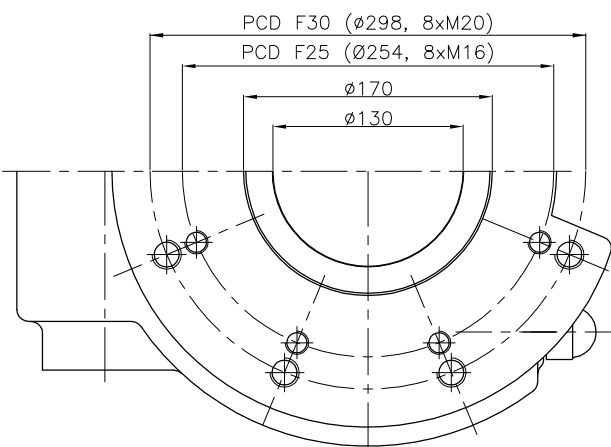
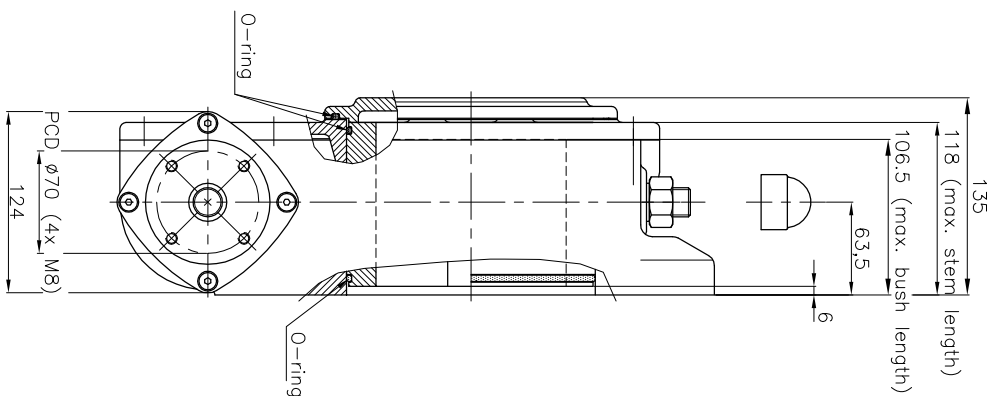
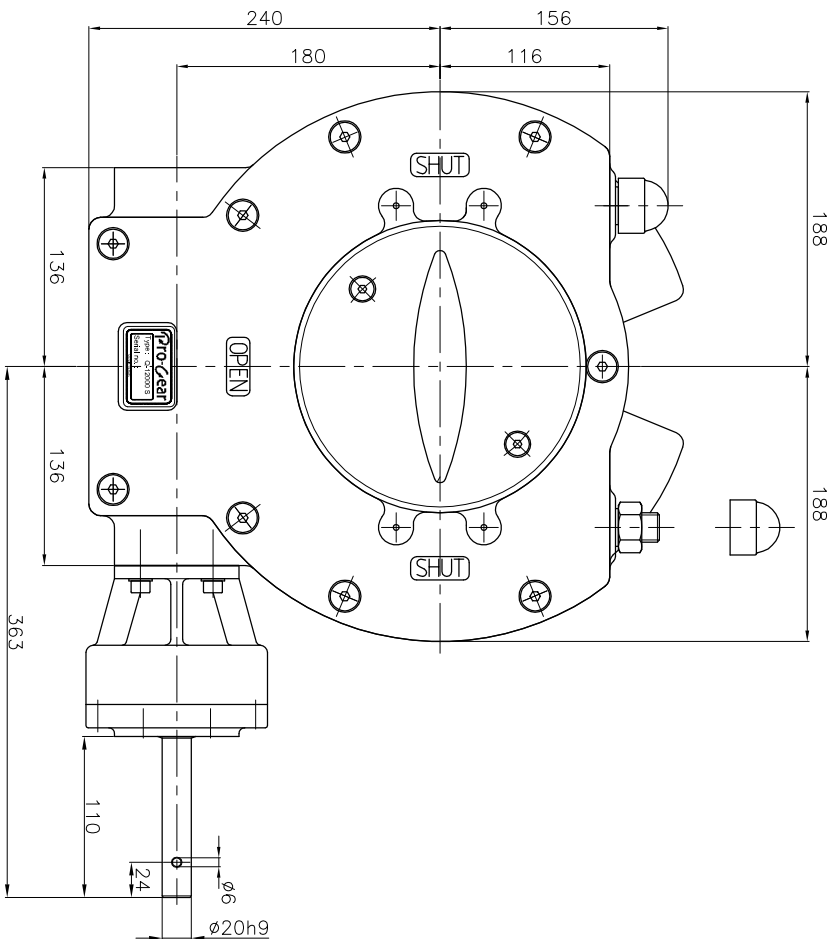

No rights can be obtained from this drawing  
Drawing can be changed without notice

## TECHNICAL DATA

NAME	: Q-12000-S
Travel	: $90^\circ \pm 5^\circ$ at both ends
RATIO	: 267 : 1 (quarter turn)
TURNS TO CLOSE	: 67
APPROX. WEIGHT	: 56,70 kg. ( 125,00 lb.) excl. bore and handwheel
MAX. INPUT TORQUE	: 168,48 Nm (124,3 lbf.ft.)
MAX. OUTPUT TORQUE	: 12000 Nm (8850,7 lbf. ft.)
MECH. ADV.	: 71% (+/- 10%) (values measured by fully loaded gearbox)

## MOUNTING DETAILS

BOLT CIRCLE	MIN. : $\phi 254$ [10.0"] 8x M16 (F25) MAX. : $\phi 298$ [11.7"] 8x M20 (F30)
BORE	MIN. : — MAX. : $\phi 130$ [5.12"] or [90 [3.54"]]

# Pro-Gear

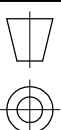

dimension in MM.

Scale : none

Drawing number :

DC-12000-S-01

Revision :

07

This document is property of PRO-GEAR GmbH. Neither this or its content may be copied or used in any other way detrimental to the interest of PRO-GEAR, acceptance of this document shall constitute acknowledgement of the foregoing conditions