

# GEARBOX TYPE: Q-20000-S

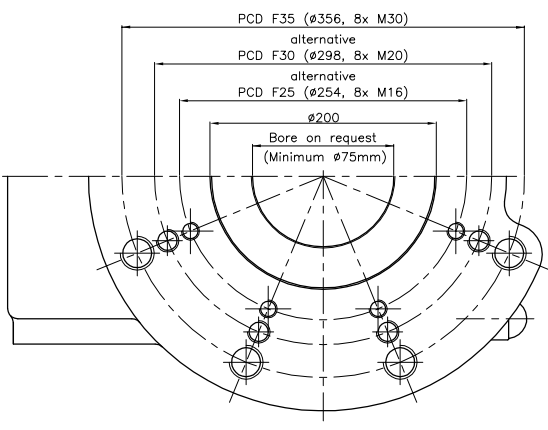

TECHNICAL DATA	
NAME	: Q-20000-S
Travel	: 90° ±5° at both ends
RATIO	: 684 : 1 (quarter turn)
TURNS TO CLOSE	: 171
APPROX. WEIGHT	: 104,8 kg. (231,04 lb.) excl. bore and handwheel
MAX. INPUT TORQUE	: 133Nm (98.1 lb.ft.)
MAX. OUTPUT TORQUE	: 20000 Nm (14751.2 lb. ft.)
MECH. ADV.	: 150.3% (+/- 10%) (Values measured by fully loaded gearbox)

MOUNTING DETAILS	
BOLT CIRCLE	MIN. : ø254 [10.0] 8x M16 (F25) MAX. : ø356 [14.01] 8x M30 (F35)
BORE	MIN. : ø75 [2.95] MAX. : ø160 [6.30"]

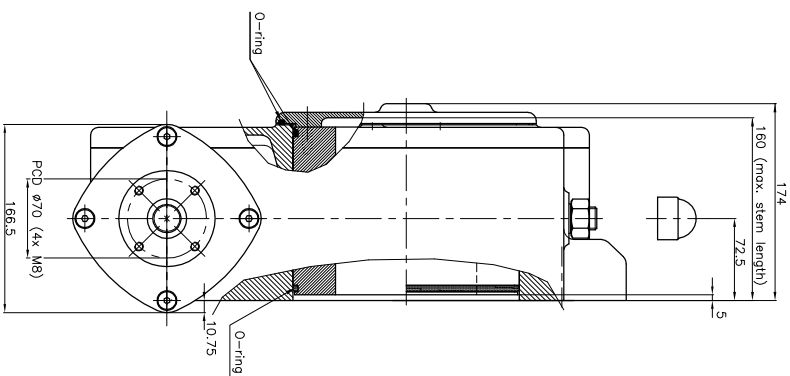
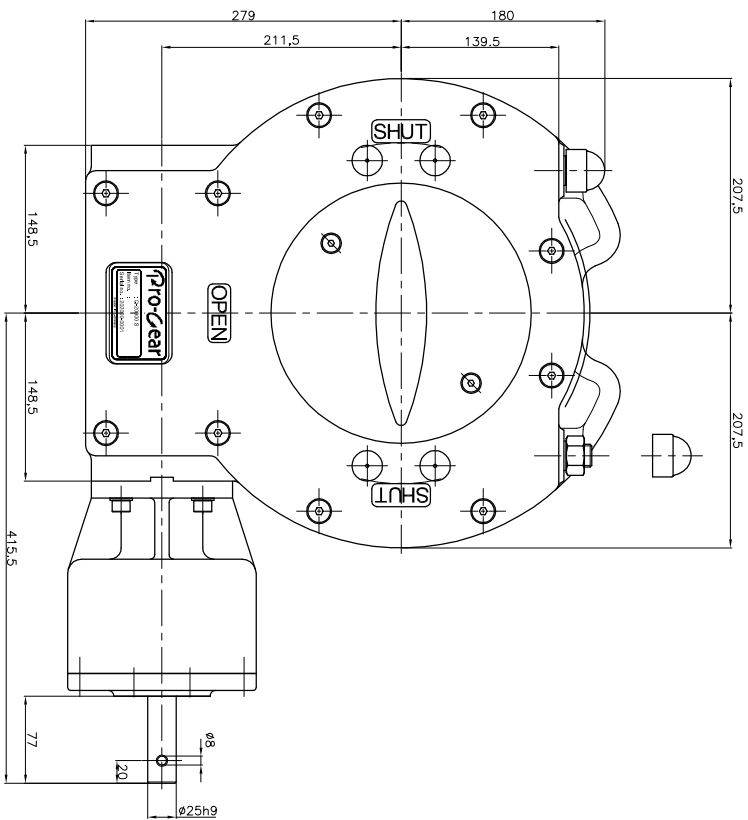
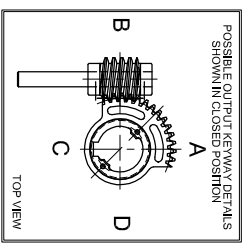

No rights can be obtained from this drawing  
Drawing can be changed without notice

# Pro-Gear

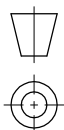

dimension in MM.

Scale : none

Drawing number : DC-Q20000-S

Revision : 00

This document is property of PRO-GEAR GmbH. Neither this or its content may be copied or used in any other way detrimental to the interest of PRO-GEAR, acceptance of this document shall constitute acknowledgement of the foregoing conditions