

GEARBOX TYPE: Q-24000-S

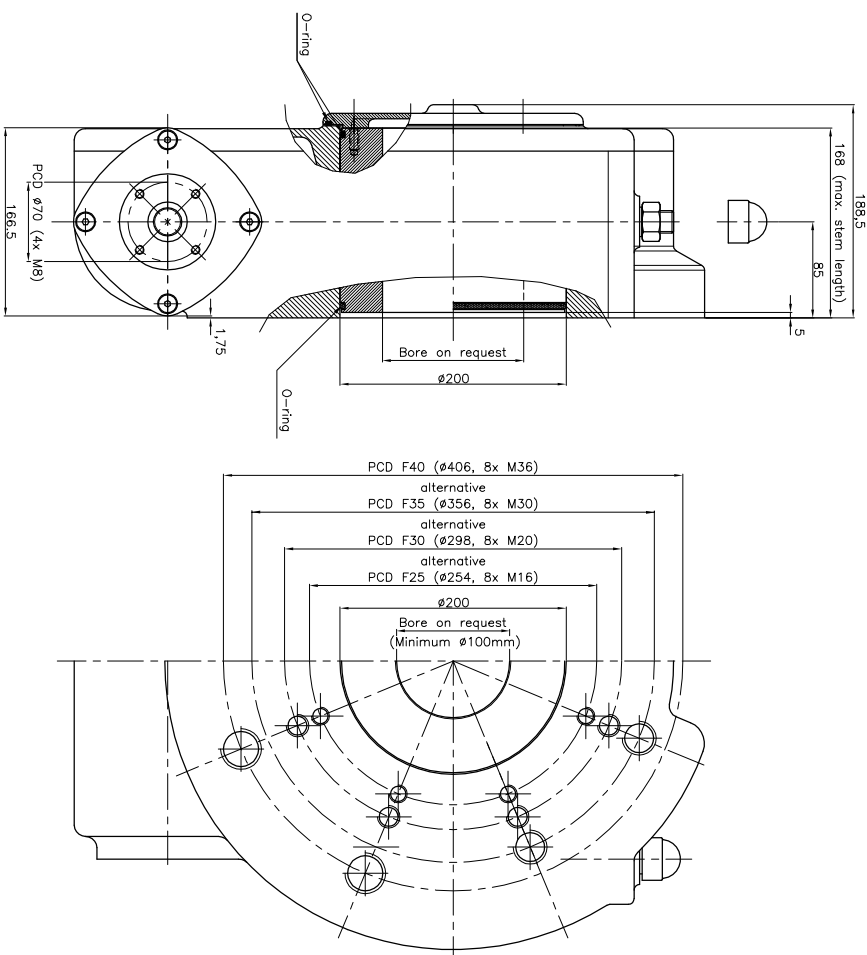

TECHNICAL DATA	
NAME	: Q-2400-S
Travel	: 90° ±5° at both ends
RATIO	: 720 : 1 (quarter turn)
TURNS TO CLOSE	: 180
APPROX. WEIGHT	: 192 kg. (423.29 lb.) excl. bore and handwheel
MAX. INPUT TORQUE	: 140Nm (103.3 lbf.ft.)
MAX. OUTPUT TORQUE	: 24000 Nm (17701.5 lbf. ft.)
MECH. ADV.	: 171.5% (+/- 10%) (Values measured by fully loaded gearbox)

MOUNTING DETAILS	
BOLT CIRCLE	MIN. : ø254 [10.0] 8x M16 (F25) MAX. : ø406 [15.98] 8x M36 (F40)
BORE	MIN. : ø80 [3.15] MAX. : ø160 [6.30"]

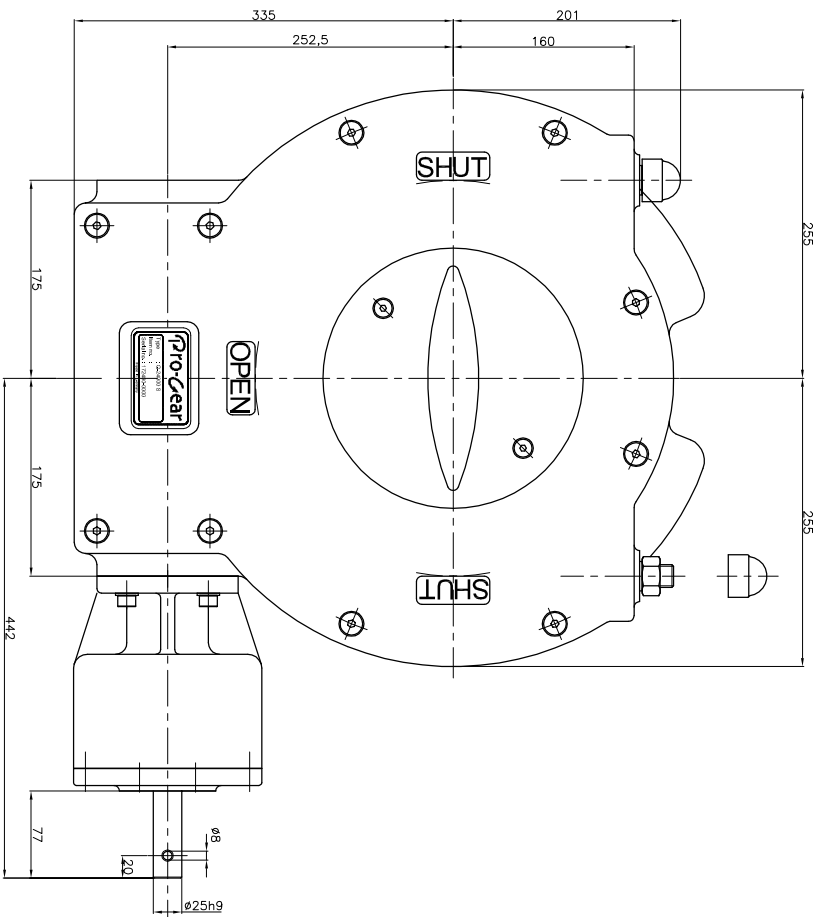
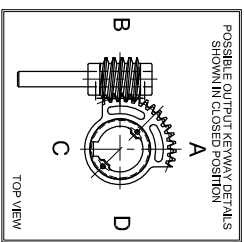

No rights can be obtained from this drawing
Drawing can be changed without notice

Pro-Gear



dimension in MM.

Scale : none

Drawing number :

DC-Q24000-S

Revision :

01

This document is property of PRO-GEAR GmbH. Neither this or its content may be copied or used in any other way detrimental to the interest of PRO-GEAR, acceptance of this document shall constitute acknowledgement of the foregoing conditions