

GEARBOX TYPE: Q-32000-S

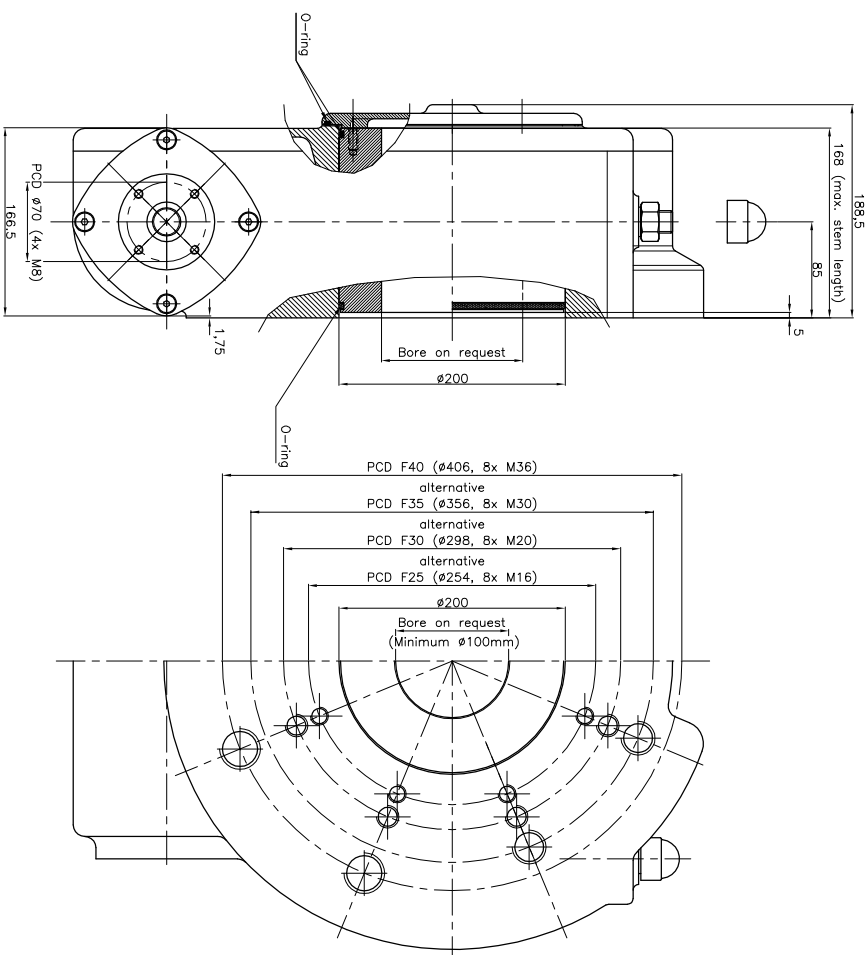
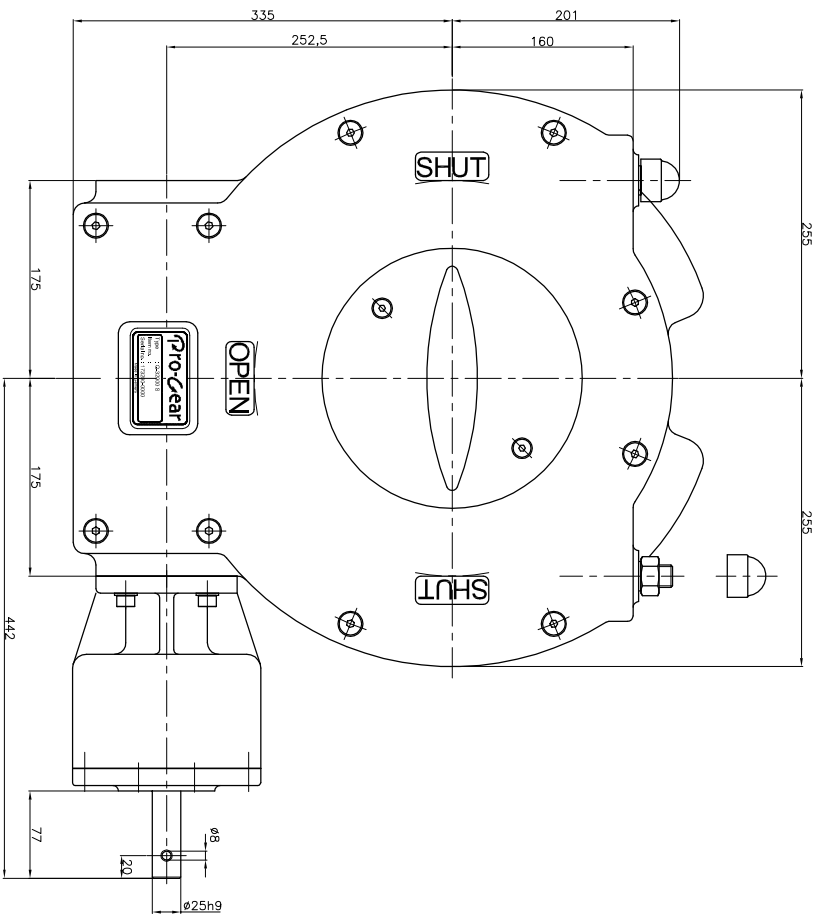

TECHNICAL DATA

NAME	: Q-32000-S
Travel	: 90° ±5° at both ends
RATIO	: 960 : 1 (quarter turn)
TURNS TO CLOSE	: 240
APPROX. WEIGHT	: 192 kg. (423.29 lb.) excl. bore and handwheel
MAX. INPUT TORQUE	: 140Nm (103.3 lbf.ft.)
MAX. OUTPUT TORQUE	: 32000 Nm (23601.9 lbf. ft.)
MECH. ADV.	: 228.6% (+/- 10%) (value measured by fully loaded gearbox)

MOUNTING DETAILS

BOLT CIRCLE	MIN. : $\varnothing 254$ [10.0] 8x M16 (F25) MAX. : $\varnothing 406$ [15.98] 8x M36 (F40)
BORE	MIN. : $\varnothing 80$ [3.15] MAX. : $\varnothing 160$ [6.30"]

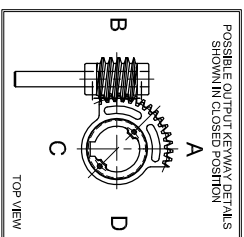

No rights can be obtained from this drawing
Drawing can be changed without notice

Pro-Gear

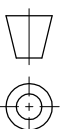

dimension in MM.

Scale : none

Drawing number :

DC-Q32000-S

Revision :

03

This document is property of PRO-GEAR GmbH. Neither this or its content may be copied or used in any other way detrimental to the interest of PRO-GEAR, acceptance of this document shall constitute acknowledgement of the foregoing conditions