

GEARBOX TYPE: Q 800-S

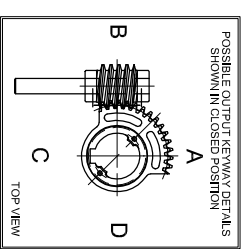
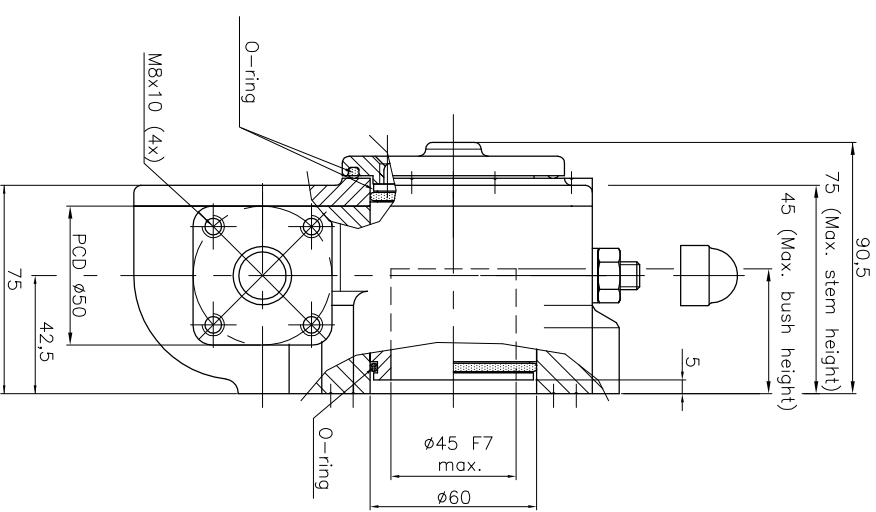
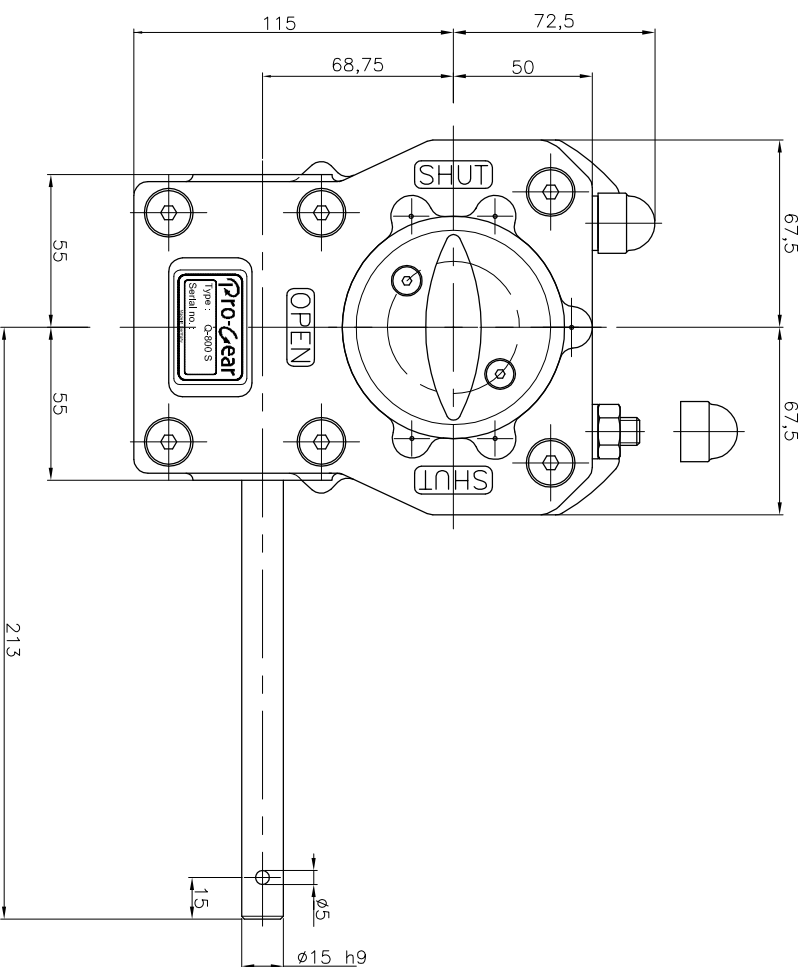

No rights can be obtained from this drawing
Drawing can be changed without notice

TECHNICAL DATA

NAME	: Q-800 S
Travel	: 90° ±5° at both ends
RATIO	: 40 : 1 (quarter turn)
TURNS TO CLOSE	: 10
APPROX. WEIGHT	: 7.68 kg. (16.93lb.) excl. bore and handwheel
MAX. INPUT TORQUE	: 60 Nm (44.25 lbf.ft.)
MAX. OUTPUT TORQUE	: 800 Nm (590.05 lbf. ft.)
MECH. ADV.	: 13.3% (+/- 10%) (Values measured by fully loaded gearbox)

MOUNTING DETAILS

BOLT CIRCLE	MIN. : $\phi 102$ [4.01] 4x M10 (F10)	MAX. : $\phi 140$ [5.51] 4x M16 (F14)
BORE	MIN. : $\phi 8.4$ (pilot-bore) or [8.0 [0.31]]	MAX. : $\phi 45$ [1.77] or [27 [01.06]]

PRO-Gear

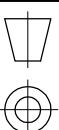

dimension in MM.

Scale : none

Drawing number : DC-800-S-01

Revision : II

This document is property of PRO-GEAR GmbH. Neither this or its content may be copied or used in any other way detrimental to the interest of PRO-GEAR, acceptance of this document shall constitute acknowledgement of the foregoing conditions