

# GEARBOX TYPE: QSS-12000-S

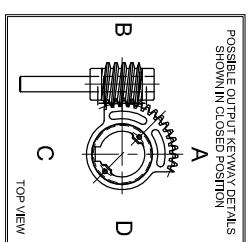
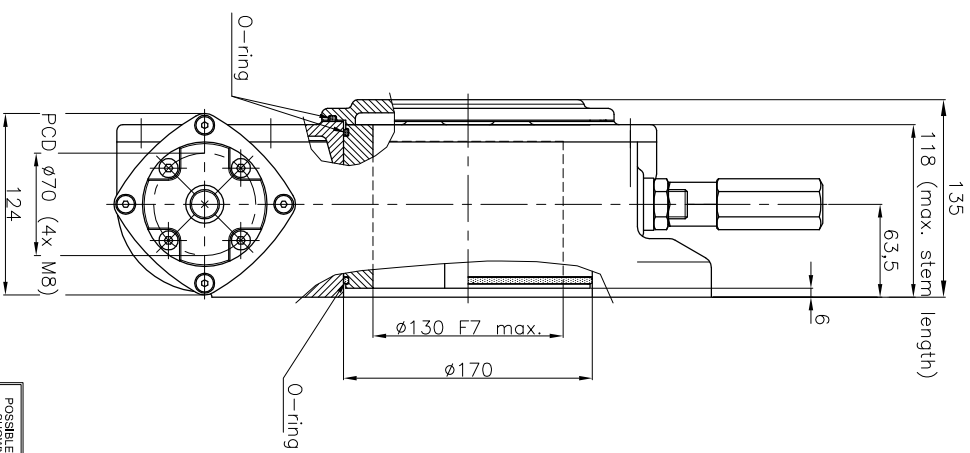
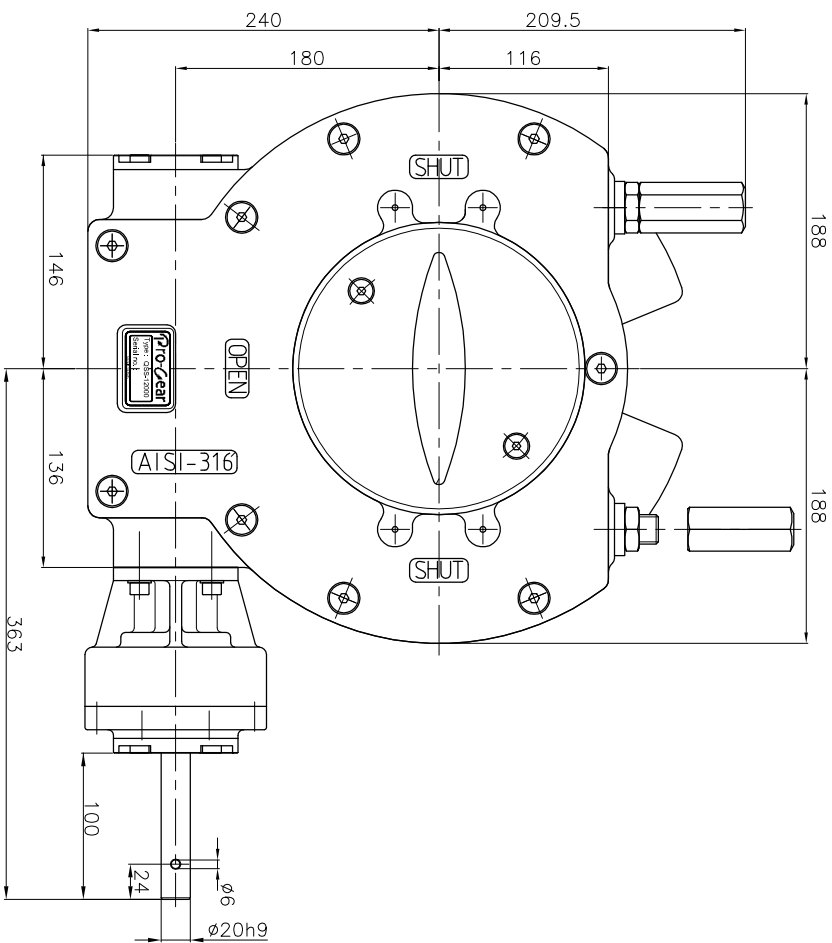

No rights can be obtained from this drawing  
Drawing can be changed without notice

## TECHNICAL DATA

NAME	: QSS-12000-S
Travel	: 90° ±5° at both ends
RATIO	: 267 : 1 (quarter turn)
TURNS TO CLOSE	: 67
APPROX. WEIGHT	: 71.20 kg. ( 156.96 lb.) excl. bore and handwheel
MAX. INPUT TORQUE	: 168,48Nm (124.3 lbf.ft.)
MAX. OUTPUT TORQUE	: 12000 Nm (8850.7 lbf. ft.)
MECH. ADV.	: 71% (+/- 10%) (values measured by fully loaded gearbox)

## MOUNTING DETAILS

BOLT CIRCLE	MIN. : $\varnothing 254$ [10.0] 8x M16 (F25) MAX. : $\varnothing 298$ [11.7] 8x M20 (F30)
BORE	MIN. : — MAX. : $\varnothing 130$ [5.12"] or [105 [4.13"]]

# Pro-Gear



dimension in MM.

Scale : none

Drawing number :

DC-QSS-12000-S-01

Revision :

00

This document is property of PRO-GEAR GmbH. Neither this or its content may be copied or used in any other way detrimental to the interest of PRO-GEAR, acceptance of this document shall constitute acknowledgement of the foregoing conditions